

32-70 41st Street

Corner of 34th Avenue - Near Entrance to R, G & V Subway

Prime Retail Space

Premises: 1,500 rsf

Term: Long Term Direct Lease

Availability: Immediate - Vacant

Asking Rent: \$4,600 per month



Features:

- At R, G, and V subway station
- New Residential Condo Building
- On-Site Parking
- Corner Space
- High Ceiling

For more information,
please contact:

Scott M. Bloom

President/Managing Member
o (212) 342-7444
m (917) 327-2109
sbloom@bloomreg.com

Bloom Real Estate Group LLC
485 Madison Avenue
New York, NY 10022
(212) 342-7444

www.bloomreg.com

BLOOM
REAL ESTATE GROUP

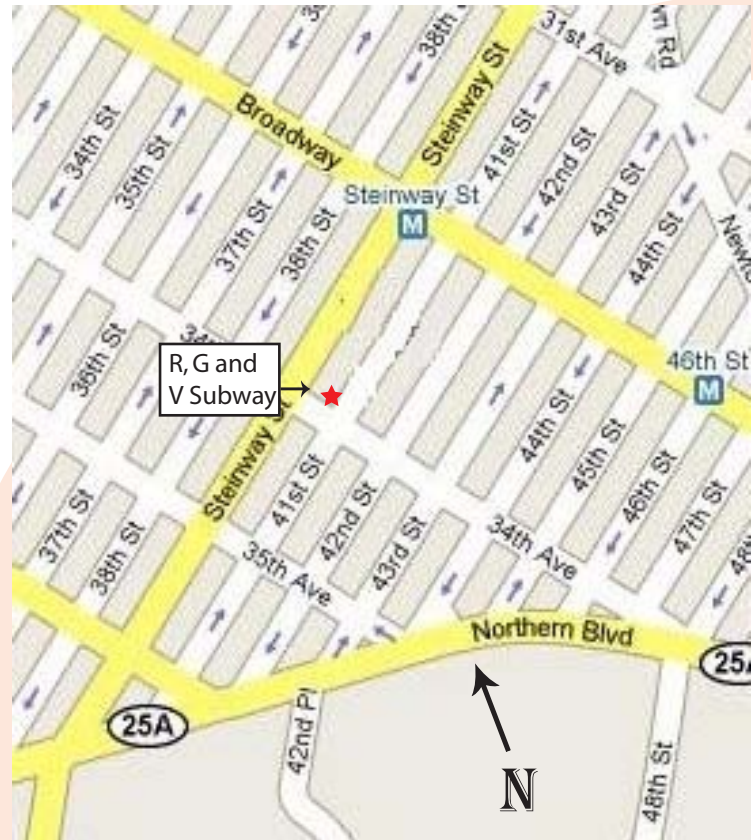

REBNY
REAL ESTATE BOARD OF NEW YORK

No representation is made to the accuracy of the information furnished herein, and same is submitted subject to errors, omissions, changes, prior sale, lease, and/or withdrawal without notice. The furnishing of this information shall not be deemed a hiring. A one-half commission, in accordance with our principal's schedule of rates and conditions, will be paid to the procuring Broker executing owner's brokerage agreement who fully consummates a transaction upon terms and conditions acceptable to our principal.

32-70 41st Street

Corner of 34th Avenue - Near Entrance to R, G & V Subway

Prime Retail Space

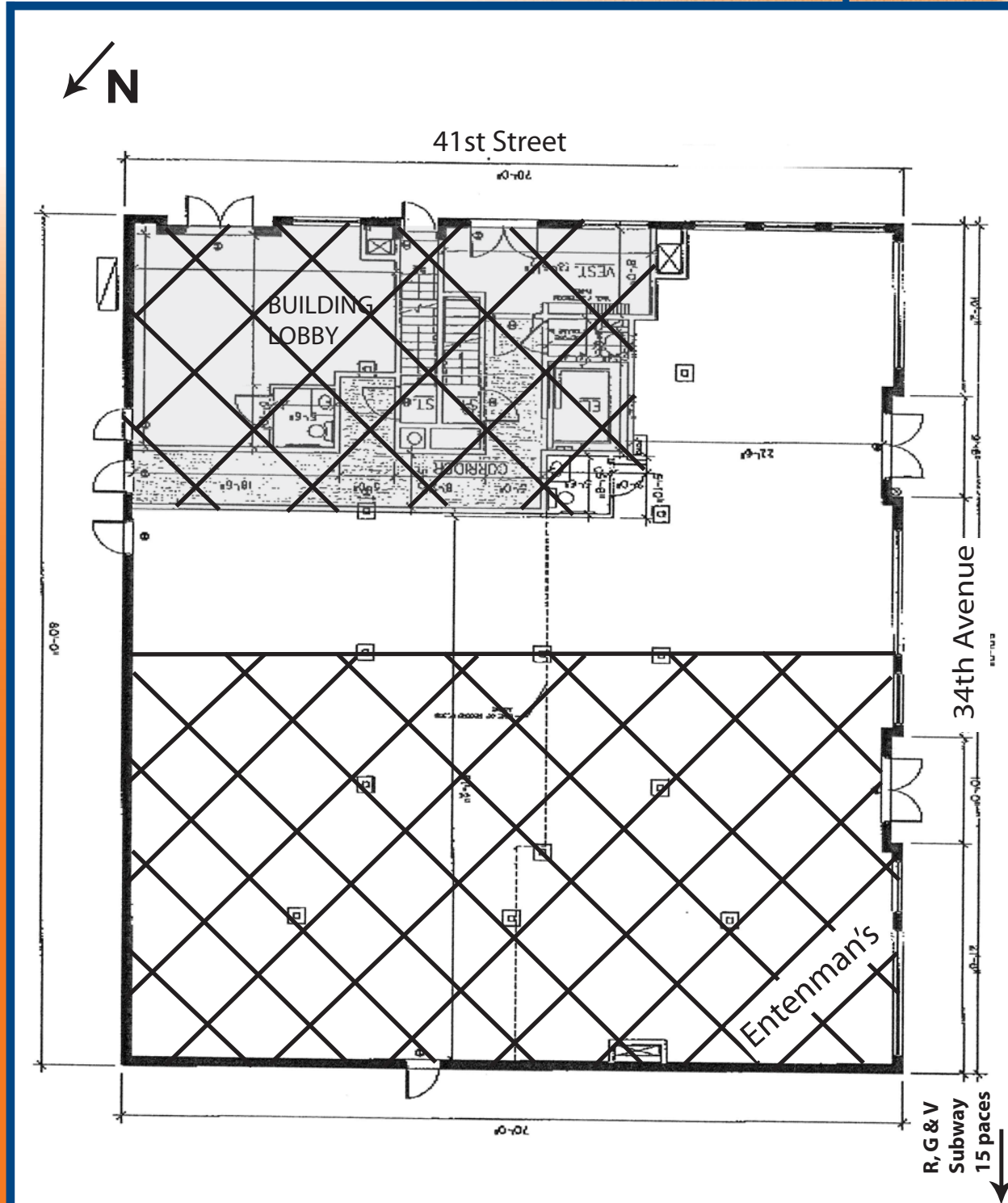

For more information,
please contact:

Scott M. Bloom

President/Managing Member

o (212) 342-7444

m (917) 327-2109

sbloom@bloomreg.com

Bloom Real Estate Group LLC

485 Madison Avenue

New York, NY 10022

(212) 342-7444

www.bloomreg.com

BLOOM
REAL ESTATE GROUP

No representation is made to the accuracy of the information furnished herein, and same is submitted subject to errors, omissions, changes, prior sale, lease, and/or withdrawal without notice. The furnishing of this information shall not be deemed a hiring. A one-half commission, in accordance with our principal's schedule of rates and conditions, will be paid to the procuring Broker executing owner's brokerage agreement who fully consummates a transaction upon terms and conditions acceptable to our principal.

REBNY
REAL ESTATE BOARD OF NEW YORK